

INDICATOR SEAL INSTALLATION (091-39-109)

1. Locate Indicator in a convenient place on the vehicle.
2. Place the template in position and center punch in 8 places.
3. Drill holes as shown.
4. Cut out opening connecting 1/2" holes together.
5. Strip jacket 3" from cable and insert cable thru seal so jacket penetrates past grommet seal.
6. Connect wiring to indicator connector in accordance with indicator installation procedure.
7. Install as shown.
8. Insert (4) #8 screws and tighten, (**CAUTION: Do not over tighten because you will bend the plastic bezel and break the watertight seal**).

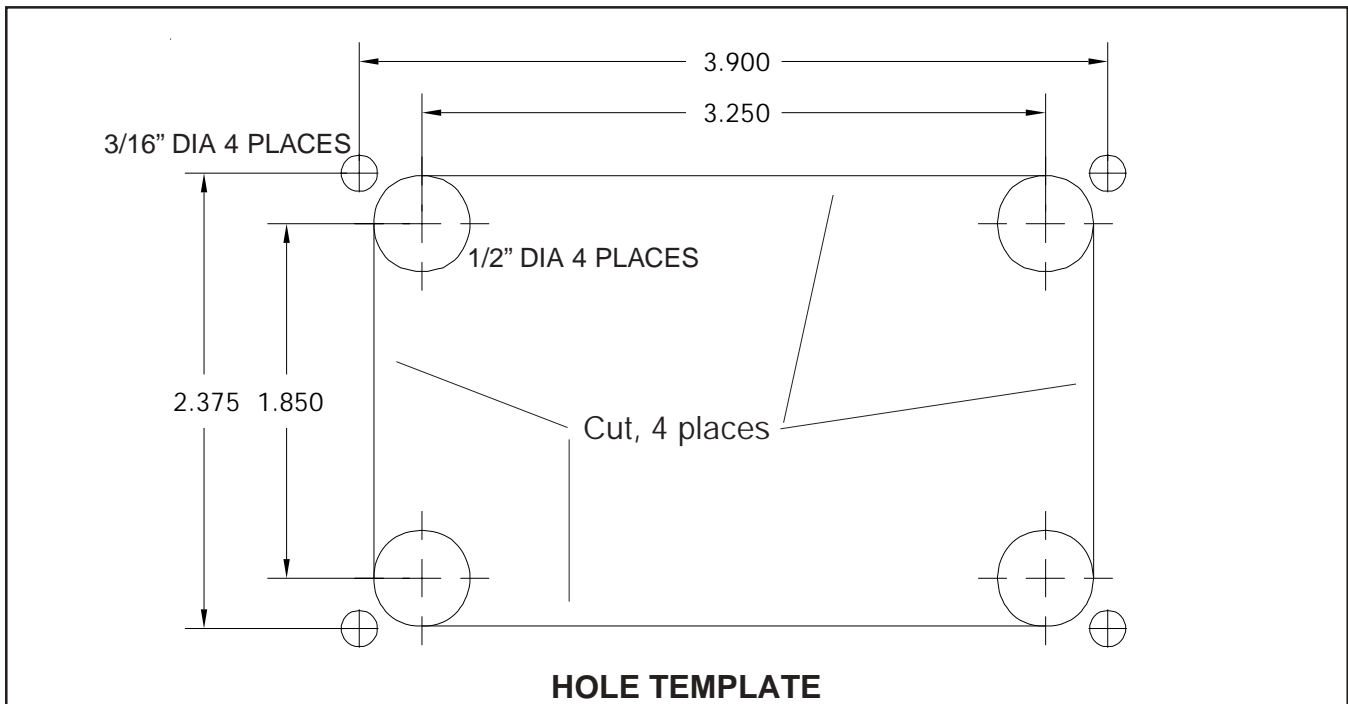
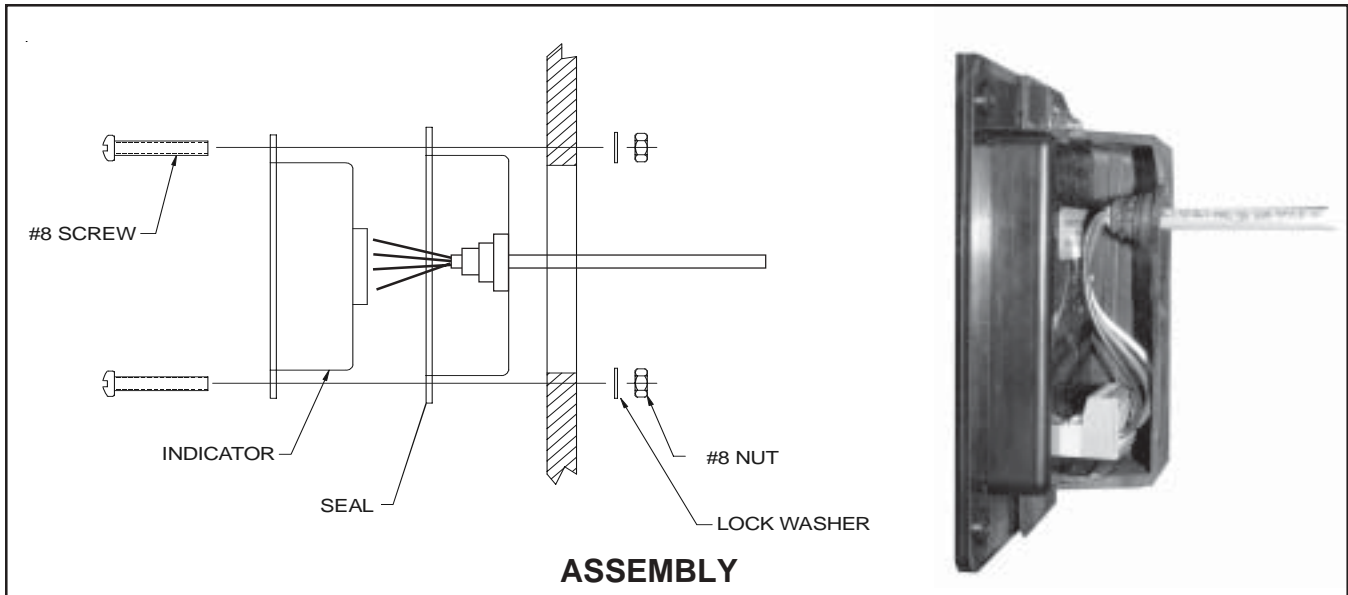

KUSSMAUL ELECTRONICS CO., INC.
170 CHERRY AVE., WEST SAYVILLE, N.Y. 11796

TEL: in NY 631-567-0314

TOLL FREE: 800-346-0857

FAX: 631-567-5826